

(see pg. 50)

THOMAS WILLING

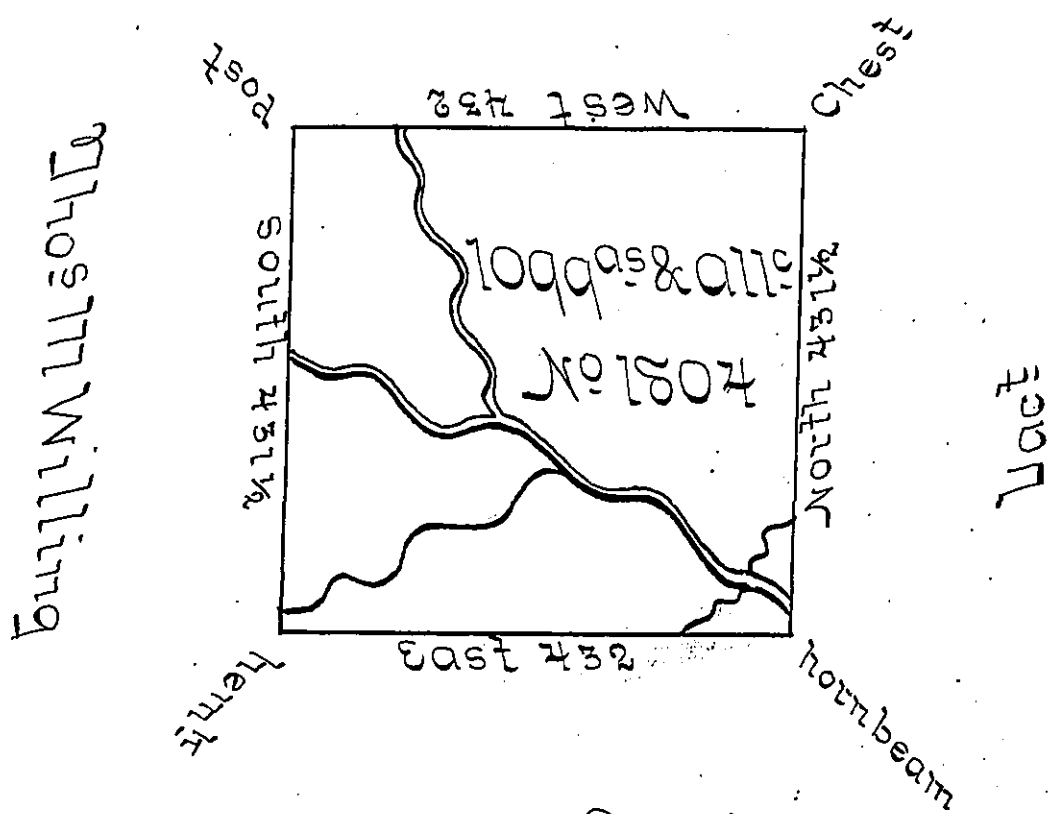

Vacant Land

In pursuance of a Warrant No 1504 dated 18th August 1792
 Surveyed November 23^d 1792 to Thomas W Willing The
 above described tract of land on the main Branch of
 Pine Creek in the late purchase Northumberland County
 in district No 2 Containing one thousand & Ninety Nine
 Acres & Allowance of six ¹/₂ Cent.

Jno Brodhead U.S.

Daniel Brodhead Esquire }
 Surveyor General ~ }

This survey was returned interfering with an old
 Survey; & is corrected and returned again 4th 1795

by William Ellis

IN TESTIMONY that the above is a copy of the original remaining on file in
 the Department of Internal Affairs of Pennsylvania, made
 conformably to an Act of Assembly approved the 16th day of
 February, 1833, I have hereunto set my Hand and caused
 the Seal of said Department to be affixed at Harrisburg,
 this fourth day of December 1900.

James W Latta
 Secretary of Internal Affairs.